

DV7 Adapter

This datasheet covers the following items:

302163	DV7-2 Adapter W24 (200 bar)
302164	DV7-3 Adapter W24 (200 bar)
303042	DV7a-2 W24 (200 bar)
303043	DV7a-3 W24 (200 bar)
304042	DV7a -2 M25 (300 bar)
304043	DV7a -3 M25 (300 bar)



General

The DV7# is used where more discharge valves are to be connected to the same INERGEN cylinder. The DV7# has two/three outlet connections and so allows two/three discharge valves to be fitted to one hand wheel valve.

Typical use is where one INERGEN bank is used for fire suppression in several zones, or when the cylinder is used for controlling purposes (pilot cylinders) as well as for extinguishing.

Material

Metal:	Brass CuZn39Bp3
O-rings:	PUR

Installation

The nut with tread T1 is screwed on to the cylinder hand wheel valve according to good workmanship for connections sealed with o-rings.

The hand wheel valve must have either M25x1.5 (300 bar) or W24.32 (200 bar) connection tread.

The DV7 can be positioned in any desirable position.

Maintenance, operating, testing

The DV7 should be cleaned regularly.

The component must be leakage tested when pressurized as per instructions with discharge valve.

No special maintenance is required.

General dimensions

P _{Work} :	400 bar
P _{Burst} :	> 1200 bar

Document: Ci DV7

Product: Adapter

Id: OLRA

Rev: 13.11.13



Vølundsvej 17
DK- 3400 Hillerød
Tel +45 7022 2769
Fax +45 7023 2769

Text

1

2

3

4

5

6

7

8

9

304042 DV7a -2 M25 (300bar)**304043 DV7a -3 M25 (300bar)****303043 DV7a -3 W24 (200bar)****Dimensions**

O-rings: 14.1×1.6 (item: 2141162)
 Flow diameter: 7 mm (38.5mm²)
 L×W×H: 62×82×40 mm
 T1 + T2: M25×1.5 (300 bar)
 W24.32 (200 bar)
 Weight: 0.90 kg

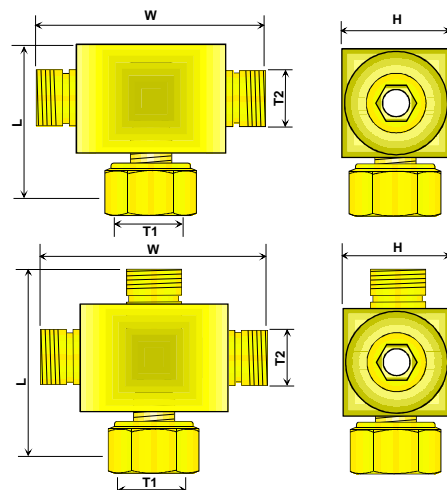
**303042 DV7a -2 W24 (200bar)****Dimensions**

O-rings: 14.1×1.6 (item: 2141162)
 Flow diameter: 7 mm (38.5mm²)
 L×W×ø: 62×109×40 mm
 T1 + T2: W24.32
 Weight: 0.95 kg

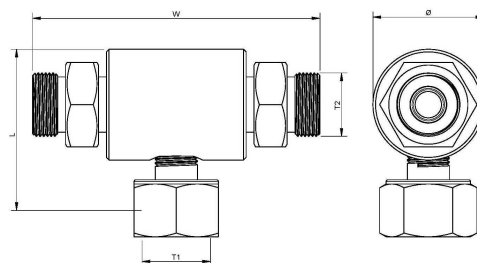
**302163 DV7-2 Adapter W24 (200bar)****302164 DV7-3 Adapter W24 (200 bar)****Dimensions**

O-rings: W24 models: 13.1×1.6 (item: 302222)
 Flow diameter: ø6 mm (28 mm²)
 L×W×H: 86×116×75
 T1 + T2: W24.32
 Weight: 2.20 kg
 P_{Work}: 400 bar

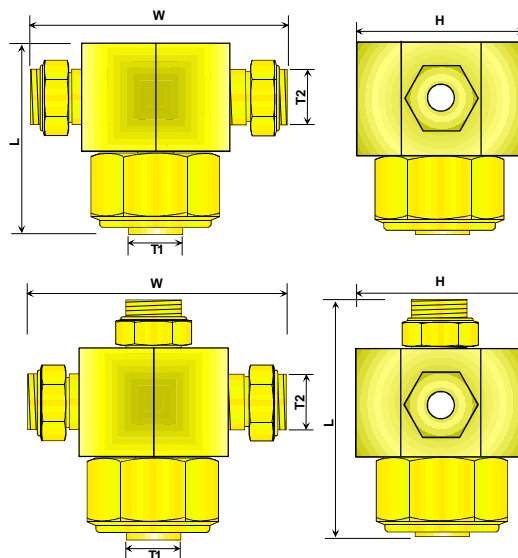

Document: Ci DV7

Product: Adapter

Id: OLRA

Rev: 13.11.13



Vølundsvej 17
 DK- 3400 Hillerød
 Tel +45 7022 2769
 Fax +45 7023 2769

Text

1

2

3

4

5

6

7

8

9