

## ZigBee IAS Motion Sensor aa

### General

The Motion Sensor lets you detect everything with only one device. The Motion Sensor can detect occupancy, light & temperature.

With the wireless Motion Sensor, your customers will be able to set lights to turn on and off as they come and go. Moreover, the temperature detector can be set to trigger smart thermostats or portable heaters.

The occupancy sensor is PIR based and is able to sense movement up to 6 meters from where the sensor is placed. The wireless protocol is Zigbee, meaning that the Motion Sensor can be integrated with other Zigbee based systems.



### Specifications

Voltage: 3VDC (1xCR123 Battery)

Battery life:

3 years, reporting every 2 min.

Battery warning: < 2.5V

Radio Features:

Sensitivity: -92 dBm

Output power: + 3dBm

Detection:

Sensitivity range: 6m

View angle: 45°

Environment

Temp.: 0°C to +50°C

IP class: IP30

Humidity: 5-85% non condensing

Dimensions

HxD: 82x82x28 mm

Weight: 0.1 kg

**Colour/Material:** White/Plastic

### Standard

ZigBee Home automation certification

### Markings

Develco

MOSZB-130

#### Document:

551301 ZigBee IAS Motion Sensor aa

#### Category:

Accessories

Id: MRP

Rev:2018.09.18



**FIRE EATER** %

Vølundsvej 17  
DK- 3400 Hillerød  
Tel +45 7022 2769  
Fax +45 7023 2769

Text

1

2

3

4

5

6

7

8

9

**Installation**

Remove the magnetic mounting base and open the casing of the sensor.

The Motion Sensor must be placed in a location with a clear view of the monitored area and the windows.

Use the sensor part with holes to mark the screw holes on a flat ceiling or a wall.

Use the enclosed screws and plugs to install the mounting base on the marked place.

Insert the battery respecting the polarities.

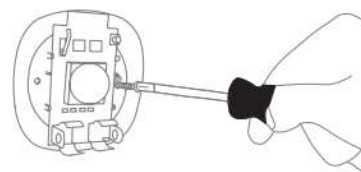
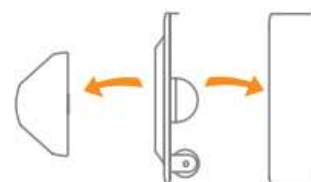
**Operating**

After installation of the batteries, The Window Sensor will now start searching (up to 15 minutes) for a Zigbee network to join.

Make sure that the Zigbee network is open for joining devices and will accept the Window Sensor.

**Factory reset:**

Open the casing of the device by pushing the fastening on top of the device to remove the front panel from the back cover.

Remove the battery and reinsert the battery.

Press and hold down the reset button for approximately 10 seconds. The button has to be pushed within one minute after inserting the batteries.



When the red light starts flashing every second, the reset process has been successfully implemented and is now ready to join the network.

After joining to the ZigBee network, attach the frontcover.

For further information, see the FLEX installation manual.

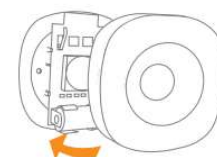
**Maintenance**

Move your body into the area of the motion sensor and check that the green LED on the device turn on.

Check also that the 'network' receive the signal.

Replace the batteries for every 3 years.

**Document:**

551301 ZigBee IAS Motion Sensor aa

**Category:**

Accessories

Id: MRP

Rev:2018.09.18

Text



**FIRE EATER %**

Vølundsvej 17  
DK- 3400 Hillerød  
Tel +45 7022 2769  
Fax +45 7023 2769