

## Reducers for INERGEN distribution

### Item numbers covered by this datasheet

70241417 Galv Reducer 241 DN20-15  
 70241427 Galv Reducer 241 DN25-20  
 70241431 Galv Reducer 241 DN32-25  
 70241436 Galv Reducer 241 DN40-32  
 70241441 Galv Reducer 241 DN50-40  
 70241442 Galv Reducer 241 DN25-15  
 70241449 Galv Reducer 241 DN32-15  
 70241450 Galv Reducer 241 DN32-20  
 70241456 Galv Reducer 241 DN40-15  
 70241457 Galv Reducer 241 DN40-20  
 70241458 Galv Reducer 241 DN40-25  
 70241463 Galv Reducer 241 DN50-15  
 70241464 Galv Reducer 241 DN50-20  
 70241465 Galv Reducer 241 DN50-25  
 70241466 Galv Reducer 241 DN50-32

70241471 Galv Reducer 241 DN65-50  
 70241472 Galv Reducer 241 DN65-25

70241480 Galv Reducer 241 DN80-65  
 70241481 Galv Reducer 241 DN80-50  
 70241482 Galv Reducer 241 DN80-25

70241473 Galv Reducer 241 DN65-20 (two fittings: DN65-50(70241471) and DN50-20(70241464))  
 70241474 Galv Reducer 241 DN65-32 (two fittings DN65-50(70241471) and DN50-32(70241466))  
 70241475 Galv Reducer 241 DN65-40 (two fittings DN65-50(70241471) and DN50-40(70241441))  
 70241476 Galv Reducer 241 DN65-15 (two fittings DN65-50(70241471) and DN50-15(70241463))

70241484 Galv Reducer 241 DN80-32 (two fittings DN80-50(70241481) and DN50-32(70241466))  
 70241485 Galv Reducer 241 DN80-40 (two fittings DN80-50(70241481) and DN50-40(70241441))  
 70241486 Galv Reducer 241 DN80-20 (two fittings DN80-50(70241481) and DN50-20(70241464))  
 70241487 Galv Reducer 241 DN80-15 (two fittings DN80-50(70241481) and DN50-15(70241463))

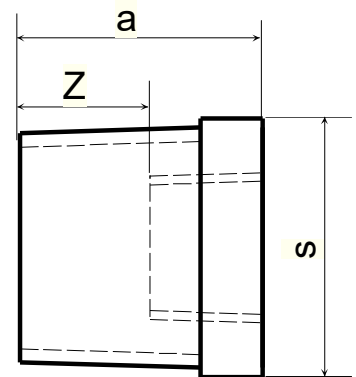

### General

Galvanised type tested threaded malleable cast iron fittings for use in high-pressure fire extinguishing systems according to Vds rules.

Some of the reducers are assembled by two 'reducers' (two fittings) to get the right reduction. (item No 70241473 to 70241487). They can also be delivered with the respective fittings.

Each dimension has been type tested @ 300bar, each individual fitting has been leak tested to verify its tightness.

<b>Document:</b> Ci Galv Reducers.docx		Text
		1
		2
<b>Category:</b>	<b>Id:</b> MRP	3
Control inert	<b>Rev:</b> 2024-05-	4
		5
		6
		7
		8
		9



Vølundsvej 17  
 DK- 3400 Hillerød  
 Tel +45 7022 2769  
 Fax +45 7023 2769

**Specifications**

Reducer:	a: [mm]	Z: [mm]	s: [mm]	Mass: [kg]	Thread: [ISO7/1]
DN20-15	26	13	30	0.05	¾"-½"
DN25-20	29	14	36	0.10	1"-¾"
DN32-25	31	14	46	0.15	1 ¼"-1"
DN40-32	31	12	50	0.15	1 ½"-1 ¼"
DN50-40	35	16	65	0.30	2" 1 ½"
DN25-15	29	16	36	0.10	1"-½"
DN32-15	31	18	46	0.20	1 ¼"-½"
DN32-20	31	16	46	0.20	1 ¼"-¾"
DN40-15	31	18	50	0.25	1 ½"-½"
DN40-20	31	16	50	0.25	1 ½"-¾"
DN40-25	31	14	50	0.20	1 ½"-1"
DN50-15	35	35	65	0.35	2"-½"
DN50-20	35	33	65	0.35	2"-¾"
DN50-25	35	18	65	0.35	2"-1"
DN50-32	35	16	65	0.35	2"-1 ¼"
DN65-25	40	37	80	0.51	2 ½"-1"
DN65-50	40	16	80	0.67	2 ½"-2"
DN80-25	44	42	95	0.63	3"-1"
DN80-50	44	20	95	0.91	3"-2"
DN80-65	44	17	96	0.99	3"- 2 ½"

**Installation**

See data sheet: 51 Pipes - Pipes regarding details for pipe system and installation.

**Marking**

Each fitting is marked with a Red dot and the letter "D" stamped into the body.

**Standards & approvals**

Fittings are rated for working pressure up to 80bar\* in extinguishing systems and 2.2 certificates are available.

EN 10242, EN10226, EN1562

\* The manufacturer may specify higher working pressure.

Document: Ci Galv Reducers.docx

Text

1

2

Category:

Control inert

Id: MRP

Rev: 2024-05-

3

4

5

6

7

8

9



Vølundsvej 17  
DK- 3400 Hillerød  
Tel +45 7022 2769  
Fax +45 7023 2769