

SV22 Pipe pressure outlet kit

General

This kit is used when a signal for pressurization of the pipe system is required.

The adapter is fitted directly into the SV22 outlet between the selector valve and the pipe adapter.

The adapter features 3 outlets, 2 of these are blinded with the supplied plugs and in the third a 6mm compression ring fitting is placed, from this outlet a 6mm tube is drawn to the remote placed pressure switch.

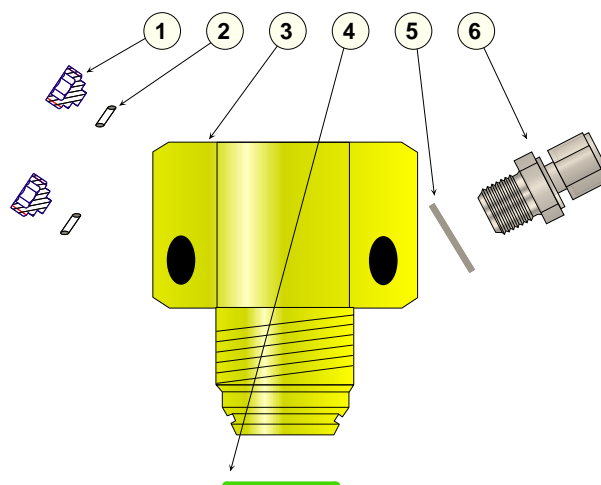

Specification

Pressure:

Work	max 400 bar
Proof (burst)	>1200 bar

Temperature:

-30 °C - +100°C

Thread:

Main flow	ISO228 1"
Outlets	1/4" iso228 and EN837

Material:

Body	Brass,
Fitting	AISI316
O-ring	PUR

Dimensions:

Weight	1 kg
Hex	55mm

Pos.	Item*	Description	Material
1	303101	Plug 1/4" BSP Manometer	Brass
2	212181	Seal Cu 1/4" Manometer	Cu
3	305280	SM22 Pipe Pressure adapter	Brass
4	2221162	O-ring 22.1x1.6	PUR
5	777203	Bonded seal 1/4 SS	aisi 316
6	4134221	Comprs fit ø6-1/4" bspp	aisi 316

*Recommended replacement item numbers.

Document: 305181 SV22 Pipe pressure outlet kit

Category:

SV-CiV System

Id: OLRA

Rev:2014.01.06



Vølundsvej 17
DK- 3400 Hillerød
Tel +45 7022 2769
Fax +45 7023 2769

Text

1

2

3

4

5

6

7

8

9

Installation

Adapter to SV22 (1)

The adapter is screwed into the outlet of the SV22. It is important to observe that the O-ring is clean and well lubricated, as well as the mating surfaces have to be clean.

Locking fluid may be applied to prevent the adapter from being unscrewed during fitting of piping, this is not a requirement. The adapter is tightened approx. 100Nm.

Pressure outlet & blind plugs

With the adapter in place the pressure outlet may be placed in any of the 3 outlets by simply removing the blind plug and the copper seal in the bottom, and fasten the pressure switch with the bonded seal fitted.

When installation is complete all unused outlets must be blinded off.

All blind plugs must be tightened until surface contact and then additional ½ turn to ensure compression of seals. The pressure outlet is only tightened til app 10Nm.

Electrical connection

The cap and cable are screwed on to the pressure switch and connected to the control panel

Brown: Com (Pressure switch: 1)
Blue: NC (Pressure switch: 2) (not pressurized pipe system)
Black: No (Pressure switch: 4) (not pressurized pipe system)

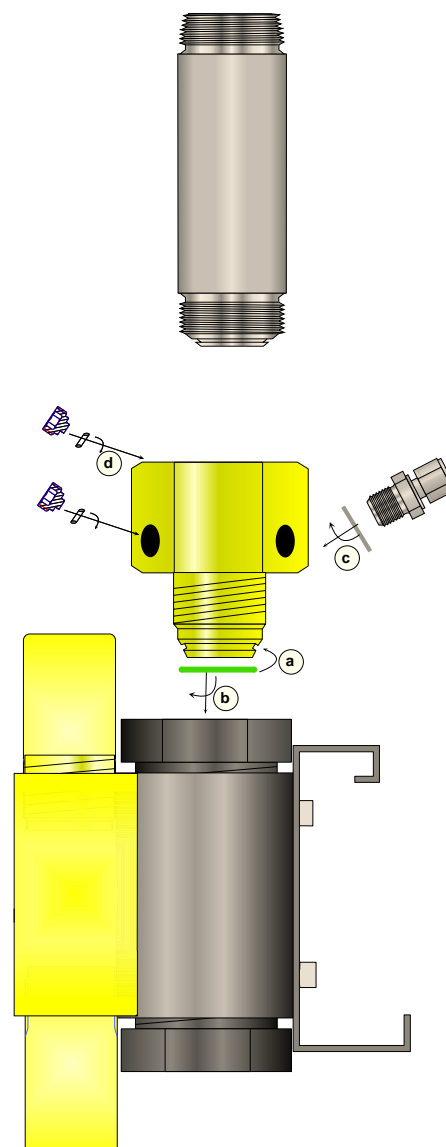

Document: 305181 SV22 Pipe pressure outlet kit

Category:

SV-CiV System

Id: OLRA

Rev:2014.01.06



Vølundsvej 17
DK- 3400 Hillerød
Tel +45 7022 2769
Fax +45 7023 2769

Text

1

2

3

4

5

6

7

8

9