

SV22 Selector valve

Item numbers covered by this datasheet

305150 SV22 Selector valve

Related components

General

Selector valve for use in INERGEN fire extinguishing systems. The valve is of the ball valve type with a pneumatic actuator and may be placed in any position. The selector valve is compatible with the Fire Eater SV22 series of equipment and should only be used with the appropriate connectors supplied with the SV22 Zone kit.

For use in systems where one common supply of INERGEN is used for protecting several rooms.

On the face of the valve there is a slot indicating the position of the valve.

For emergency opening of the selector valve the "Tool SV22 Reset", item 305149, may be used.

Specifications

Pressure

Work: 0-400
Proof (burst): > 1200 bar

Temperature -20 to +70°C

Flow way 400mm² (ø22mm)

Activation

Triggering pres.: 35-400 bar
Min.: 35 bar
Max. no triggering: 1 bar, 10 sec

Tread connections

Flow port (in&out): ISO228G 1"
Pneum. activation: ISO228 ¼" (60° seat)

Function

Operation time: < 1 sec
Fully open after activation.

Materials

Brass, Electroplated steel, EPDM,FKM, PU

Dimension

LxHxW: 160x92x90 mm
Weight: 4.3 kg

Markings

Fire Eater Logo, SV22, Serial number
CE1116, 08, EN12094-5, Inert Gas, 400bar, -20 to +70°C
Actuator 35-400 bar

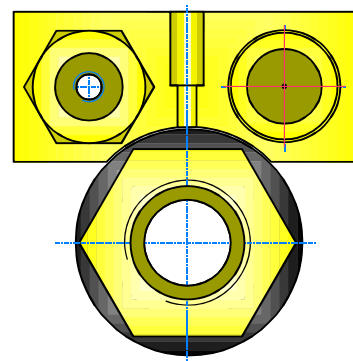
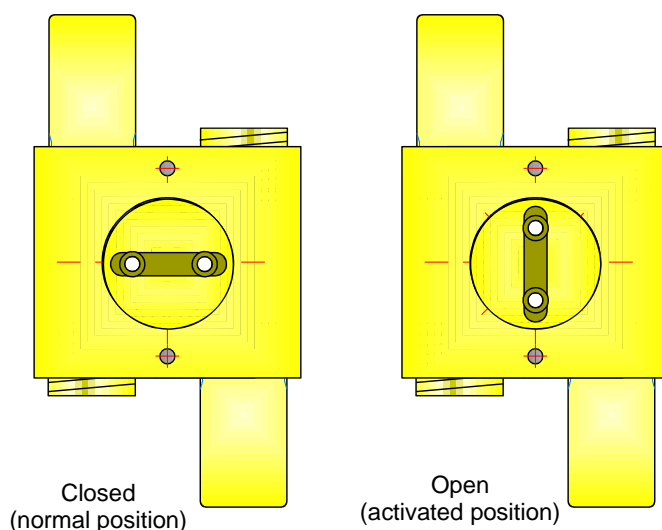

Document: 305150 SV22 Selector valve		1	Text
		2	
Category: SV-CiV system	Id: MK	3	
	Rev: 2012.10.17	4	
		5	
		6	
		7	
		8	
		9	



Vølundsvej 17
DK- 3400 Hillerød
Tel +45 7022 2769
Fax +45 7023 2769

Installation

The valve may be positioned freely.

If additional equipment is installed on the SV22, plugs may have to be removed on installation site. Instructions provided with this equipment are to be followed very carefully.

This SV22 selector valve, item no. 305150, is included in the SV22 Classic Zone kit ISO, item no. 305160, which should be used on standard installations.

Operating

The valve is opened pneumatically by pressurizing the control ports. For correct operation both ports must be pressurized.

The valve has to be reset manually by using item 305149, Tool: SV22 Reset tool. The pneumatic actuation circuitry must be depressurized before the valve can be reset.

Maintenance

Operate at least once a year.

Verify that the required pneumatic pressure does not exceed the specifications (35 bar with both ports pressurized simultaneously). This may be verified with a gauge class 1.0.

Valve has to be closed manually after activation.

One the side of the actuator there is a plastic blow-out plug to prevent dangerous pressurization of the actuator in case of internal leakages, this plug must ALWAYS be fitted to the actuator, if removed during actuation it must be put back.

Another plug is placed in the connection thread for additional equipment installation.

Section drawings

When the valve is closed, the two pistons are all the way in the top of the cylinder.

When it is fully opened they are stopped by the end plugs.

Notice: The valve is not to be disassembled by the installer or any other personnel. During production the cylinder and end stop is adjusted to achieve fully open and fully closed position, the threads are then sealed.

Only Fire Eater equipment should be attached.

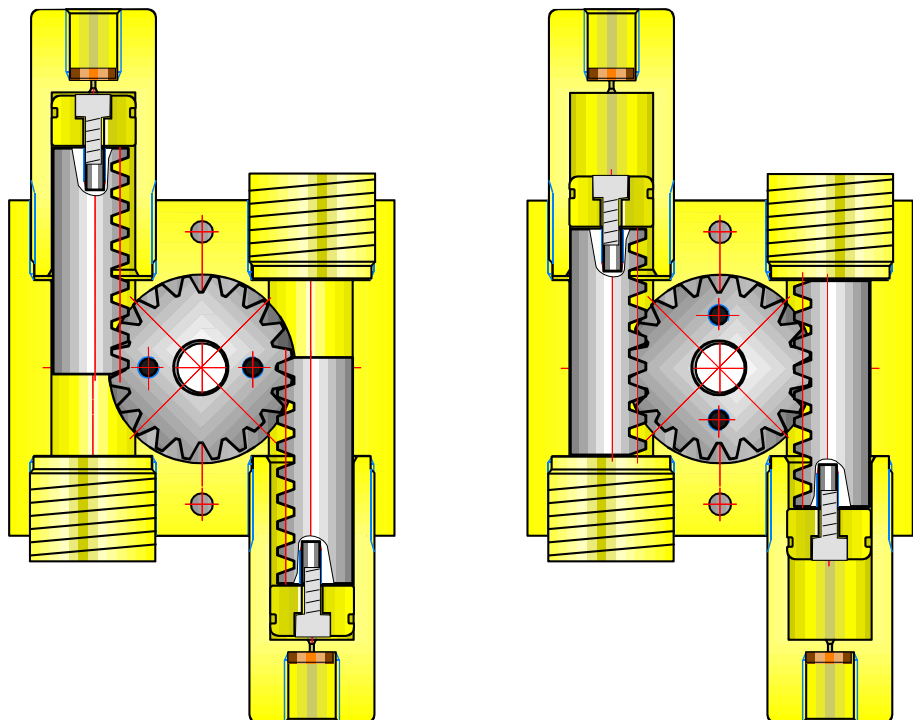

Document: 305150 SV22 Selector valve		Text
		1
		2
Category:	Id: MK	3
SV-CiV system	Rev: 2012.10.17	4
		5
		6
		7
		8
		9



Vølundsvej 17
 DK- 3400 Hillerød
 Tel +45 7022 2769
 Fax +45 7023 2769

Exploded view

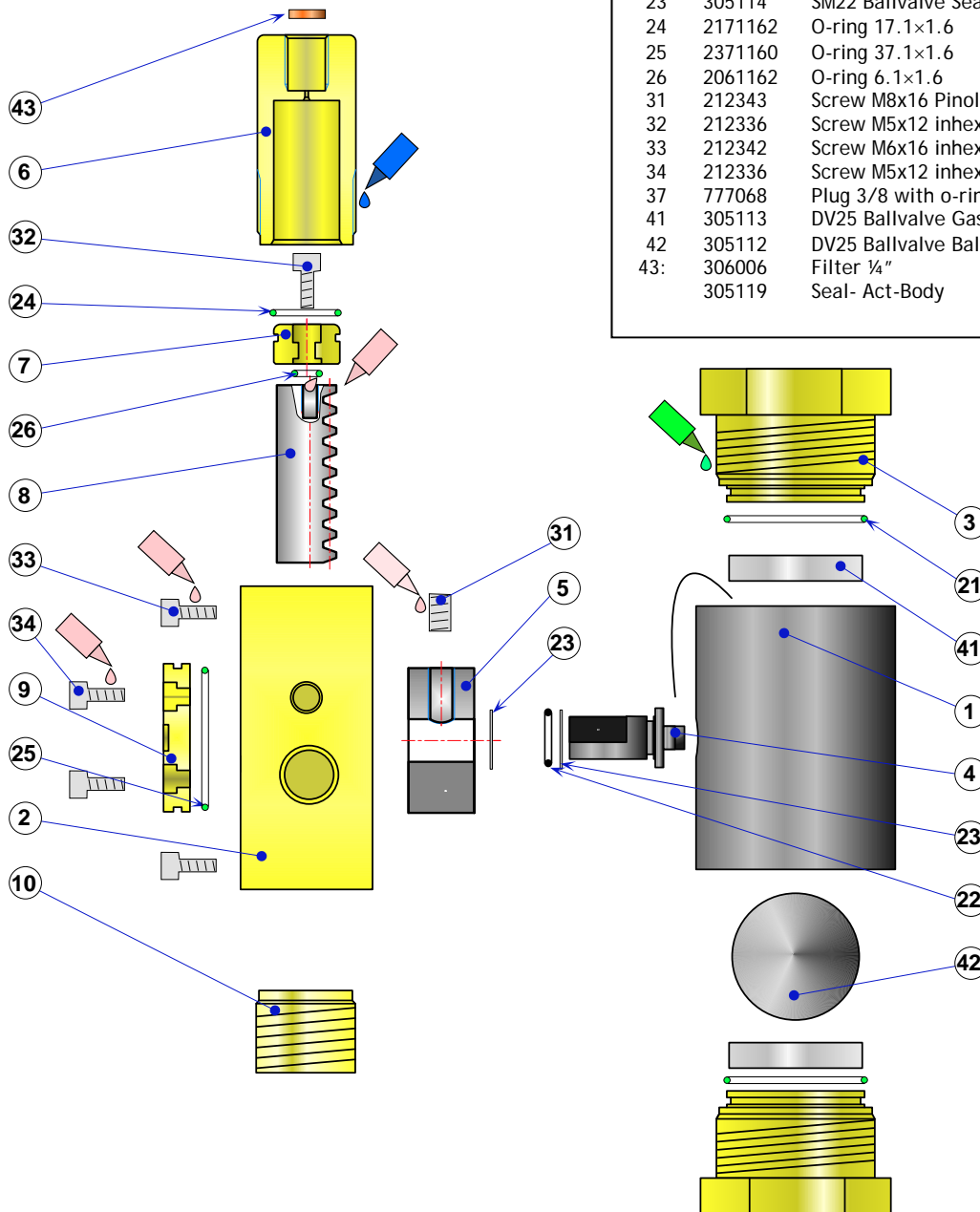

Pos.	Item	Description	Material
1:	305110	SM22 Ballvalve Body	St + Zn 10 μ
2:	305102	SM22 Actuator Body	Brass
3:	305117	SM22 Ballvalve End	Brass
4:	305116	SM22 Ballvalve Key	St + Zn 10 μ
5:	305105	SM22 Actuator Gear	St + Zn 10 μ
6:	305103	SM22 Actuator Cylinder	Brass
7:	305106	SM22 Piston top	Brass
8:	305104	SM22 Actuator Piston	St + Zn 10 μ
9:	305108	SM22 Act. Cover	Brass
10:	305109	SM22 Act. End cover	Brass
21:	2371162	O-ring 37.1x1.6	PU
22:	2101162	O-ring 10.1x1.6	PU
23:	305114	SM22 Ballvalve Seal	PTFE
24:	2171162	O-ring 17.1x1.6	PU
25:	2371160	O-ring 37.1x1.6	EPDM
26:	2061162	O-ring 6.1x1.6	PU
31:	212343	Screw M8x16 Pinol	SS
32:	212336	Screw M5x12 inhex	SS
33:	212342	Screw M6x16 inhex	SS
34:	212336	Screw M5x12 inhex	SS
37:	777068	Plug 3/8 with o-ring	Brass
41:	305113	DV25 Ballvalve Gasket	POM
42:	305112	DV25 Ballvalve Ball	St + Ni 8 μ r
43:	306006	Filter 1/4"	Brass
	305119	Seal- Act-Body	EPDM

Document: 305150 SV22 Selector valve

Text

Category:
SV-CiV system



Id: **MK**
Rev: **2012.10.17**



Vølundsvej 17
DK- 3400 Hillerød
Tel +45 7022 2769
Fax +45 7023 2769

1	
2	
3	
4	
5	
6	
7	
8	
9	

Declaration of conformity & EC certificate (CPD)

	
Manufacturer:	Fire Eater A/S Vølundsvej 14 DK-3400 Hillerød Denmark
EN12094-5 High pressure selector valve with actuator for Inert gas fire extinguishing systems SV22 Selector valve Nominal diameter DN22	
Certification body for this product is CNPP, B.P. 2265, F-27950 Saint Marcel, www.cnpp.com CNPP certificate: 1116-CPD-033	
Signature:  Michael Kroneder, Technical manager Date: 2012-10-12	

Other Approvals

Det Norske Veritas (2008)

Document: 305150 SV22 Selector valve		1	Text
		2	
Category: SV-CiV system	Id: MK	3	
	Rev: 2012.10.17	4	
		5	
		6	
		7	
		8	
		9	



Vølundsvej 17
 DK- 3400 Hillerød
 Tel +45 7022 2769
 Fax +45 7023 2769

Declaration of Performance

DoP No: Ci HWV 2016-02

SV22 (Selector valve)

	eng	dan	fra	ger	spa	pol	cze	rus
Construction Product Regulation EN12094-5	Declaration of Performance Applied standards	Ydeevneerklæring Anvendte standarder	Déclaration de performance Normes appliquées	Leistungserklärung Angewandte Normen	Declaracion de prestaciones Normas Aplicadas	Deklaracji właściwości użytkowych Zastosowane normy	Prohlášení o vlastnostech Aplikované normy	Декларация Performance Примененные стандарты
	Specifications	Specifikationer	Caractéristiques	Technische Daten	Especificaciones	Dane techniczne	Specifikace	характеристики
"SV22", Fire Eater logo, "inert gas" 40MPa, -20 to +70C	Identification	Identifikation	Identification	Identifizierung	Identificación	Identyfikacja	Identifikace	идентификация
Selector valve for multizone inert gas fire suppression system	Intended use	Anvendelsesformål	Utilisation prévue	Anwendungen	Aplicaciones	Aplikacje	Aplikace	Назначение
Fire Eater A/5 Vølundsvvej 14, DK-3400 Hillerød Denmark	Manufacturer	Producent	Fabricant	Hersteller	Fabricante	Producent	Úrobnce	производитель
CNPP Cert 1116-CPR-033 CNPP GH 08 00 06 System 1	Authority Certificate Test report	Myndighed Certificat Testrapport	Autorité Certificate Rapport d'essai	Zertifizierung Zertifikat Test rapport	Certificación Certificado Report Prueba	Certyfikacja Certyfikat Raport testowy	Osvědčení Certifikát Zkušební Report	сертификация сертификат протокол испытания
-20 to +70 °C	Temperature Operating Installation Storage	Temperatur Brug Installation Opbevaring	Température d'exploitation Installation Stockage	Temperatur Betriebs- Installation Lagerung	Temperatura Operativo Instalación Almacenamiento	Temperatura Operacyjny Instalacja Przechowywanie	Teplota Provozní Instalace Skladování	Температура операционная установка хранение
Ø22mm 400 mm ² 4.3 kg	Flow way Diameter Area	Lysning Diameter Areal	Écoulement Diamètre Aire	Flow Weg Durchmesser Areal	Camino de flujo Diámetro Área	Sposób przepływu Średnica Obszar	Flow cesta Průměr Rozloha	поток способ диаметр площадь
40 MPa (400 bar) >120 MPa (1200 bar)	Weight Pressure Work Destructive test pressure	Vægt Tryk Arbejds- Destruktivt prøvningstryk	Poids Pression Travail éclater	Gewicht Druck Arbeit platzen	Peso Presión Trabajo Burst	Waga Ciśnienie Praca Burst	Hmotnost Tlak Práce Roztržení	вес Давление работа взрыв
3.5-40 MPa (@ WP 40MPa)	Activation Pressure Voltage Current Force	Aktivering Tryk Volt Strøm Kraft	Activation Pression Tension Courant Force	Aktivierung Druck Spannung Strom Kraft	Activación Presión Voltaje Corriente Fuerza	Aktywacja Ciśnienie Napięcie Prąd Siła	Aktivace Tlak Napětí Energie Síla	активация Давление напряжение текущий сила
na	No Triggering Max pressure	Ingen Aktivering Max tryk	Pas de déclenchement max pression	keine Triggerung Max Presse	No Disparo Presión Max	Nie Wyzwalanie Max naciśnij	Ne Spouštění Max lis	нет триггера Макс пресс-
ISO228/1 G1" ISO228/1 G1" ISO228/1 G1/4"	Thread connection Inlet Outlet Accessories	Gevindtilslutning Inlet Outlet Tilbehør	Raccord filetage Prise Sortie Accessoires	Gewindeanschlüsse Einlass Ausgang Zubehör	Conexiones rosca Entrada Salida Accesorios	Przyłącza gwintowane Wlot Wylot Akcesoria	závitové připojení Vstupní Odtok Příslušenství	Резьбовые соединения вход выход аксессуары
Any	Installation Mounting direction	Installation Monterings-retning	Installation Sens de montage	Installation Montagerichtung	Instalación Dirección de montaje	Instalacja Kierunek montażu	Instalace Směr montáže	Установка направление монтажа
na	Smallest cylinder	Mindste beholder	Le plus petit cylindre	kleinste Zylinder	Cilindro más pequeño	Najmniejszy cylinder	Nejmenší válec	Наименьший цилиндр

Document: DoP SV22 2016-06

Category: DOP

Id: MK
Rev:2016.06.27



Vølundsvvej 17
DK- 3400 Hillerød
Tel +45 7022 2769
Fax +45 7023 2769

FIRE EATER A/S

Text

1

2

3

4

5

6

7

8

9

Declaration of Performance

DoP No: Ci HWV 2016-02

	eng	dan	swe	nor	fin	nld	ita
Construction Product Regulation EN12094-5	Declaration of Performance Applied standards	Ydeevneerklæring Anvendte standarder	Prestandadeklaration Tillämpade standarder	Ydeevneerklæring Anvendte standarder	Julustus Performance Applied standardit	Prestatieverklaring Toegepaste normen	Dichiarazione di prestazione Norme applicate
	Specifications	Specificationer	Specifikation	Specifikation			
"SV22", Fire Eater logo, "Inert gas" 40MPa, -20 to +70C	Identification	Identifikation	Identifisering	Identifikasjon	tunnistaminen	Identifikation	Identificazione
Selector valve for multizone inert gas fire suppression system	Intended use	Anvendelsesformål	Avsedd användning	Tiltenkt bruk	tarkoitettu käyttö	Beoogd gebruik	Applicazioni
Fire Eater A/S Vølundsevej 14, DK-3400 Hillerød Denmark	Manufacturer	Producent	Tilverkare	Produsent	valmistaja	Fabrikant	Fabbricante
CNPP Cert 1116-CPR-033 CNPP GH 08 00 06 System 1	Authority Certificate Test report	Myndighed Certificat Testrapport	Myndighet Certificat Testrapport	Myndighet Certificat Testrapport	sertifiointi todistus Testraportti	Certificering Certificat Test rapport	certificazione certificato prova Raport
-20 to +70 °C	Temperature Operating Installation Storage	Temperatur Drift- Installation Opbevaring-	Temperatur Drift- Installation Lagring	Temperatur Drifts- Installasjon Lagring	Lämpötila käyttö- asennus varastointi	Temperatuur Bedrijfs- Installatie Opslagruimte	Temperature Operative Installazione Immagazzinamento
Ø22mm 400 mm ² 4.3 kg	Flow way Diameter Area Weight	Flow Diameter Areal Vægt	Mynning Diameter Areal Vikt	Flow Diameter Område Vekt	Flow tavalla halkaisija alue paino	Flow weg Diameter Areal Gewicht	Flow Diametro Area Peso
40 MPa (400 bar) >120 MPa (1200 bar)	Pressure Work Destructive test pressure	Tryk Arbejds- Destruktivt prøvningstryk	Tryck Arbets- Destruktivtesttryk	Trykk Arbeid- Destruktivt prøvningstryk	paine työ burst	Druk Werk Burst	Pressione lavoro scoppiare
3.5-40 MPa (@ WP 40MPa)	Activation Pressure Voltage Current Force	Aktivering Tryk Volt Strøm Kraft	Aktivering Tryck Spänning Ström Kraft	Aktivisering Trykk Spenning Strøm Kraft	aktivointi paine jännite nykyinen voima	Activering Druk Voltage Stroom Kracht	Attivazione pressione voltaggio corrente forza
na	No Triggering Max pressure	Ingen aktivering Max tryk	Ingen aktivering Max tryck	Ingen utløsende Max trykk	ei Triggering max paina	Geen Triggering Max druk	No trigger stampa Max
ISO228/1 G1" ISO228/1 G1" ISO228/1 G1/4"	Thread connection Inlet Outlet Accessories	Gevindtilslutning Inlet Outlet Tilbehør	Gånganslutning Inlet Outlet Tillbehör	Tråd tilkobling Inlet Outlet Tilbehør	kierriliitokset tuloaukko pistorasia lisälaitteet	Draad verbindingen Inlet accessoires	Le filettature insenatura presa accessori
Any	Installation Mounting direction	Installation Monteringsretning	Installation Monteringsriktning	Installation Monteringsretningen	asennus asennussuunnassa	Installatie Montagerichting	Installazione direzione di montaggio
na	Smallest cylinder	Mindeste beholder	Minsta behållare	Minste beholder	pienin sylinteri	Kleinste houder	Il più piccolo cilindro

Document: DoP SV22 2016-06

Category: DOP

Id: MK

Rev:2016.06.27



Vølundsevej 17
DK- 3400 Hillerød
Tel +45 7022 2769
Fax +45 7023 2769

FIRE EATER A/S

Text

1

2

3

4

5

6

7

8

9

Declaration of Performance

DoP No: Ci HWV 2016-02

eng	est	lav	lit	hrv	hun	por	slv
Construction Product Regulation EN12094-5	Toimivusdeklaratsioonid Applied standardid	Deklarācija Performance Lietisīkās standarti	Eksploatacinū savybūq deklaracijos Taikomoji standartai	Izjava o obavljaju primijenile standarde	Érdekében nyilatkozni Alkalmazott szabványok	Declaração de desempenho normas Aplicadas	Vyhlašenía o parametroch aplikované normy
Specifications							
Identification	identifitseerimine	identificēšana	identifikācija	identifikacija	azonosítás	identificação	identifikācia
Intended use	Kavandatud kasutus	Paredzētā izmantošana	paskirtis	Namjena	rendeltetészerű használat	uso pretendido	aplikācia
Manufacturer	tootja	ražotājs	gamintojas	proizvođač	gyártó	fabricante	Výrobca
Authority Certificate Test report	sertifikaat tunnistus Test report	sertifikācija apliecība testa ziņojums	pažymėjimas pažymėjimas Bandymų ataskaitos	potvrda certifikat izvješće o ispitivanju	hitelesítés bizonyítvány vizsgálati jelentés	certificação certificado relatório de teste	osvedčenia certifikát skúšobné Raport
Temperature Operating Installation Storage Flow way Diameter Area Weight Pressure Work Destructive test pressure Activation Pressure Voltage Current Force No Triggering Max pressure Thread connection Inlet Outlet Accessories Installation Mounting direction Smallest cylinder	Temperatuur tegevus- paigaldamine ladustamine Flow viis läbimõõt ala kaal surve töö Burst aktiveerimine surve pinge praegune joud No ülitusega Max vajutage Teema ühendused sisseviik pistikupesa lisandid paigaldamine Paigaldus suund Väikseim silindri	Temperatūra darba uzstādīšana glabāšana Flow veids diametrs platība svaris spiediens darbs Burst aktivizācija spiediens spriegums strāva speks NĒ izraisot Max prese vītņu savienojumi pievads kontaktilgizda piederumi uzstādīšana Montāžas virziens mazākais cilindrs	Temperatūra Operacinė montavimas saugojimas srauto būdas skersmuo plotas svoris slėgis darbas Burst aktyvinimas slėgis įtampa dabartinis jėga Nėra suveikimas Maksimalus spaudos Temos jungtys jėjimas anga priedai Montavimas Tvirtinimo kryptis Mažiausias cilindras	Temperatura radni instalacija skladištenje način protoka promjer područje težina pritisak posao Burst aktiviranje pritisak napon struja sila Ne pokreće Maks pritisnite veze temu uvala ispust pribor instalacija Montaža smjer najmanji cilindri	Hőmérséklet üzemeltetési telepítés tárolás flow módon átmérő terület súly nyomás munka Burst aktiválás nyomás feszültség jelenlegi erő nem kapcsolású max nyomja menetes csatlakozás beömlőnyílás kivezetés tartozékok telepítés szerelési irány legkisebb henger	Temperatura Operação instalação armazenamento Abertura Diâmetro área peso pressão trabalho Explosão ativação Pressão Tensão Corrente Vigor Sem Triggering Max imprensa com conexões de rosca entrada saida acessórios instalação sentido de montagem menor cilindro	Teplota prevádzkové inštalácia skladovanie flow cesta priemer plocha hmotnosť tlak práca roztrhnutie Aktivácia tlak napätie Tok sila nie Spúšťanie max lis závitové pripojenie vstupné odtok prístušenstvo inštalácia smer montáže najmenší valec

Document: DoP SV22 2016-06

Category:
DOP

Id: MK
Rev:2016.06.27



Vølundsvvej 17
DK- 3400 Hillerød
Tel +45 7022 2769
Fax +45 7023 2769

FIRE EATER A/S

Text

1

2

3

4

5

6

7

8

9

Declaration of Performance

DoP No: Ci HWV 2016-02

	eng	mlt	ron	bul	gre
Construction Product Regulation EN12094-5	Declaration of Performance Applied standards	Dikjarazzjoni ta' Prestazzjoni standards applikati	Declaratia de performantă standardele aplicate	Декларация за експлоатационни показатели Приложна стандарти	Δήλωση Απόδοσης Εφαρμοσμένη πρότυπα
	Specifications				
"SV22", Fire Eater logo, "Inert gas" 40MPa, -20 to +70C	Identification	identifikazzjoni	identificare	Идентифициране	αναγνώριση
Selector valve for multizone inert gas fire suppression system	Intended use	użu maħsub	utilizarea prevăzută	предназначение	προβλεπόμενη χρήση
Fire Eater A/S Vølundsvvej 14, DK-3400 Hillerød Denmark	Manufacturer	manifattur	producător	Производител	κατασκευαστής
CNPP Cert 1116-CPR-033 CNPP GH 08 00 06 System 1	Authority Certificate Test report	ċertifikazzjoni ċertifikat rapport tat-test	certificare certificat raport de încercare	Сертифициране сертификат Протокол от изпитването	πιστοποίηση πιστοποιητικό έκθεση δοκιμής
-20 to +70 °C	Temperature Operating Installation Storage	Temperatura operativa installazzjoni ħazna	Temperature operare instalare depozitare	Температура експлоатационен монтаж съхранение	Θερμοκρασία Λειτουργικά εγκατάσταση αποθήκευση
Ø22mm 400 mm ² 4.3 kg	Flow way Diameter Area	mod fluss dijametri qasam	mod Flow diametru zonă	Flow начин диаметър област	τρόπο ροής διάμετρος Περιοχή
40 MPa (400 bar) >120 MPa (1200 bar)	Weight Pressure Work Destructive test pressure	piz pressjoni xogħol jinfaqax	greutate presiune muncă burst	тегло налягане работа Burst	Βάρος πίεση εργασία Burst
3.5-40 MPa (@ WP 40MPa)	Activation Pressure Voltage Current Force	attivazzjoni pressjoni vultaġġ kurrenti forza	activarea presiune voltaj current forță	активиране налягане волтаж ток сила	δραστηριοποίηση πίεση τάση ρεύμα δύναμη
na	No Triggering Max pressure	ebda attivazzjoni istampa Max	nu Triggering press max	Не Възбуждане Max натиснете	καμία ενεργοποίηση max Τύπου
ISO228/1 G1" ISO228/1 G1" ISO228/1 G1/4"	Thread connection Inlet Outlet Accessories	konnessioni/jiet ħajt inlet outlet accessorji	conexiuni filet admisie priza accesorii	Нишка връзки впускателен изход аксесоари	συνδέσεις με σπείρωμα είσοδος έξοδος αξεσουάρ
Any na	Installation Mounting direction Smallest cylinder	installazzjoni direzjoni immuntar cilindru iżgħar	instalare Direcția de montare Cel mai mic cilindru	Монтаж Монтаж посока Най-малък цилиндър	εγκατάσταση Τοποθέτηση κατεύθυνση μικρότερη κύλινδρο

Document: DoP SV22 2016-06

Category:
DOP

Id: MK
Rev:2016.06.27



Vølundsvvej 17
DK- 3400 Hillerød
Tel +45 7022 2769
Fax +45 7023 2769

FIRE EATER %s

Text

1
2
3
4
5
6
7
8
9