

Class 6000 elbow

Item numbers covered by this datasheet

76090806	ASTM 6000 Elbow 1" npt
76090808	ASTM 6000 Elbow 1 1/2" npt
76090809	ASTM 6000 Elbow 2" npt

General

High-strength galvanized cast iron fittings conforming to ASME B16.11, for use in high-pressure fire extinguishing systems. The class 6000 marking ensures mechanical properties of the fittings have been verified.

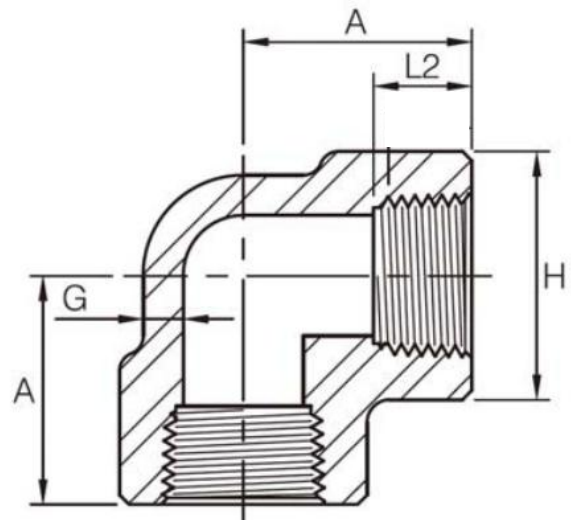

Specifications

Nominal Size	DN	A	H	G	L2	Weight
	mm	mm	mm	mm	mm	kg
1"	25	51	62	9,93	17,3	1,62
1 1/2"	40	64	84	11,07	18,4	3,57
2"	50	83	102	12,09	19,2	6,16

Marking

In line with ASME B16.11, the fittings are marked with the material grade, Class, size, and manufacturer.

Installation

See data sheet: 51 Pipes - Pipes regarding details for pipe system and installation

Standards

Pipe fittings are rated for working pressure up to 400bar in extinguishing system. Certificates with material composition and mechanical properties are available.

Dimensions: ASME B16.11

Thread: ASME B1.20.1

Material: ASTM A105